

INSTALLATION INSTRUCTIONS

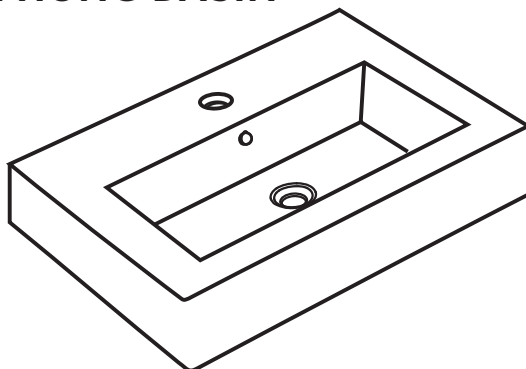

BASIN | SIERRA® WALL HUNG BASIN

30917A-1-0



BEFORE YOU BEGIN:

Please read these instructions carefully to familiarize yourself with the required tools, materials, and installation sequences. Follow the sections that pertain to your particular installation. This will help you to avoid costly mistakes. In addition to proper installation, follow all warnings, cautions and instructions contained in this guide.



IMPORTANT

CAUTION: Risk of personal injury or product damage. Handle with care. Product can break, chip, or cause injury if handled carelessly. Get help lifting the basin.

CAUTION: Risk of personal injury. This wall mount basin is heavy. Do not attempt to lift or install the wall mount basin without assistance.

ATTENTION:

- Observe all local plumbing and building codes.
- Prior to installation, unpack the basin from the carton and inspect it for any damage.
- Return the basin to its protective carton until you are ready to install it.
- The walls and the floor must be square, plumb, and level.
- Fixture dimensions are nominal and conform to tolerances established by ISO Standards.
- Care must be taken when drilling into walls to avoid any hidden pipes or wires.

NOTE:

It is the responsibility of the installer to ensure that the installation complies with council and local authority bylaws.

TOOLS AND MATERIALS REQUIRED:

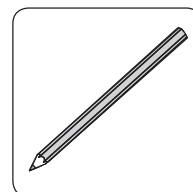
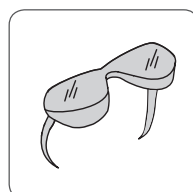
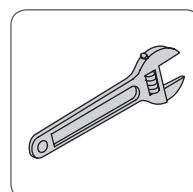
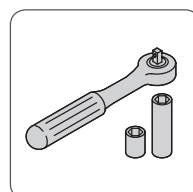
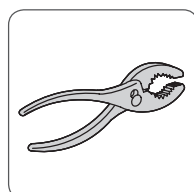
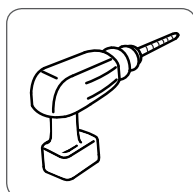
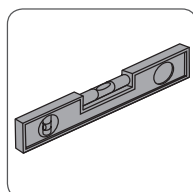
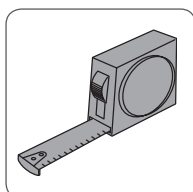
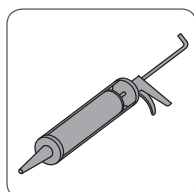

INSTALLATION - BASIN



Roughing-in may vary by product type. To avoid potential issues, verify all related product rough-in information prior to install.

1. Mark the two basin fixing hole locations on the wall.

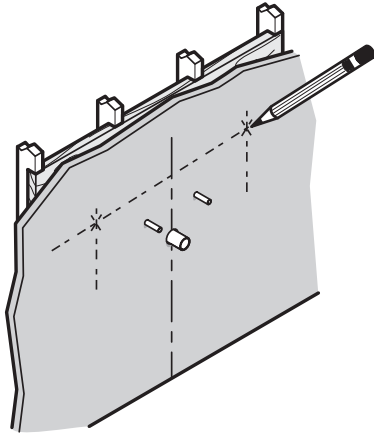

2. Drill Ø8 mm holes at the marked locations. (For Masonry wall, drill Ø10mm anchor holes. Insert wall plugs into masonry wall if required).

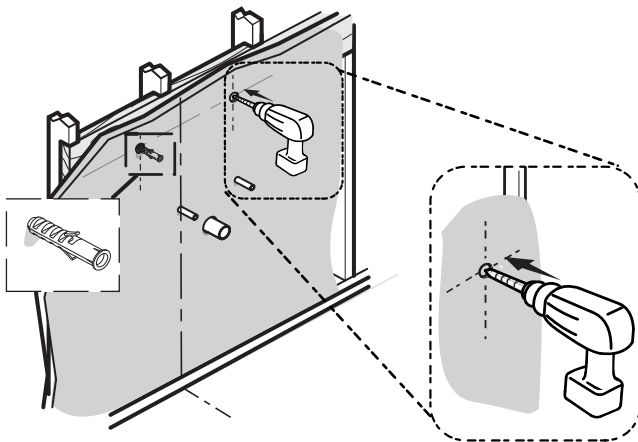

3. Install the basin mixer and waste and drain to the basin.

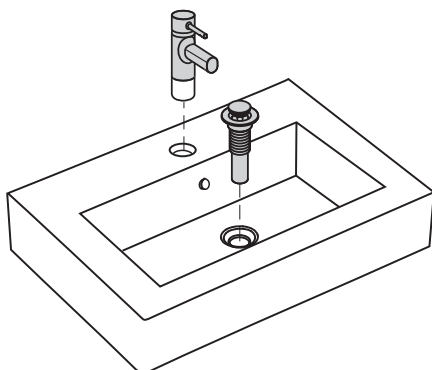

4. Screw the fixing screws into the wall using a spanner on the flat section. Leave 43mm of thread to protrude from the finished wall. Refer Fig. 1.

Fixing Screw Wall Installation

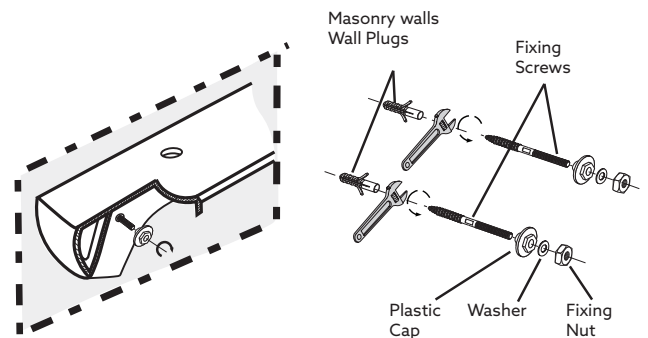
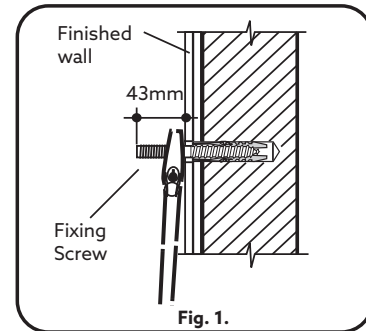

5. Connect the waste to the trap & the basin mixer to the water supply.

6. All edges **MUST** be sealed with an approved silicone sealant and ensure to wipe away any excess silicone immediately on the wall edges.

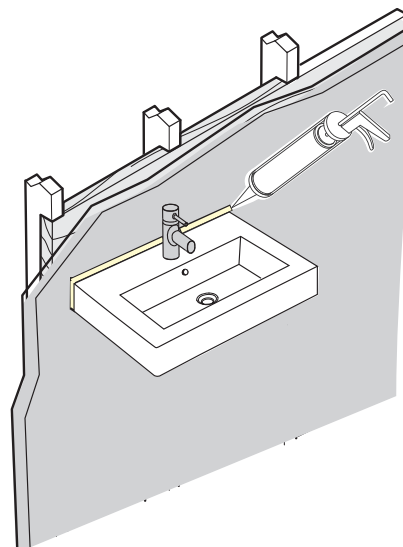

SHROUD INSTALLATION (Optional)

1. With assistance, carefully position and center the shroud tight against the underside of the basin.
Check shroud is level and secured against basin.

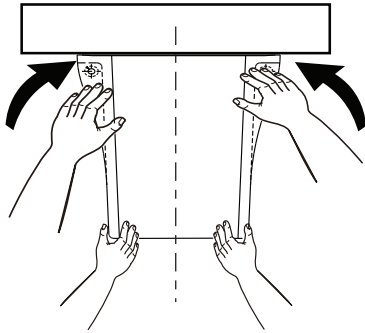

2. Mark the two shroud fixing holes on the wall.

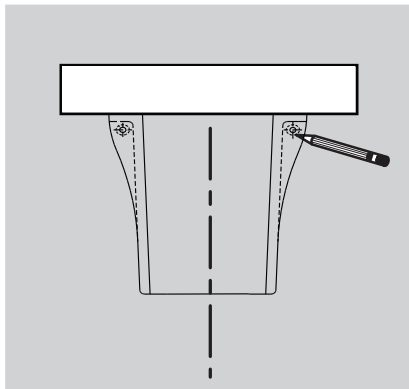

3. Carefully remove the shroud.

4. Drill Ø8 mm holes at the marked locations.
(For Masonry wall, drill Ø10mm anchor holes.
Insert wall plugs into masonry wall if required).

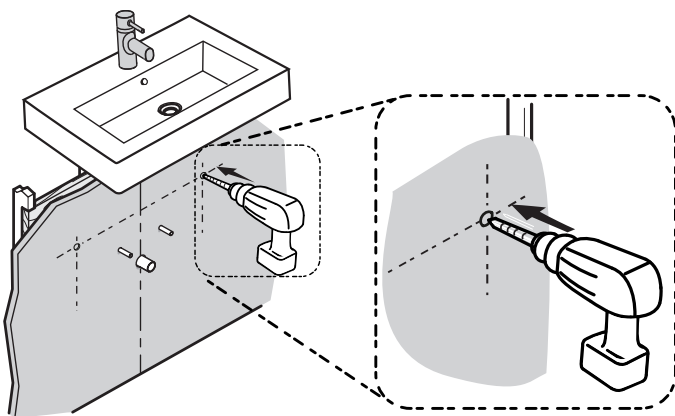

5. Position the shroud under the basin & fix securely to the wall using the supplied fixing kit, as shown in Fig. 1



DO NOT OVER TIGHTEN, AS THIS MAY CRACK THE SHROUD SIDE WINGS.

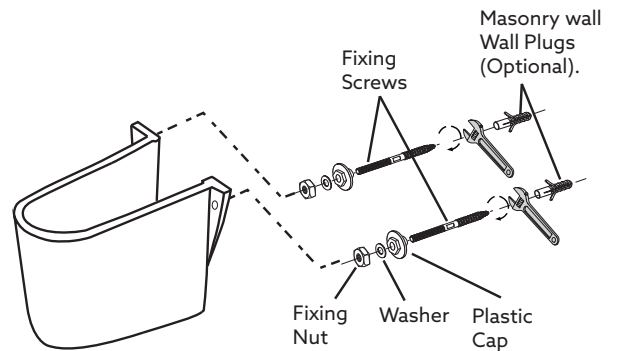
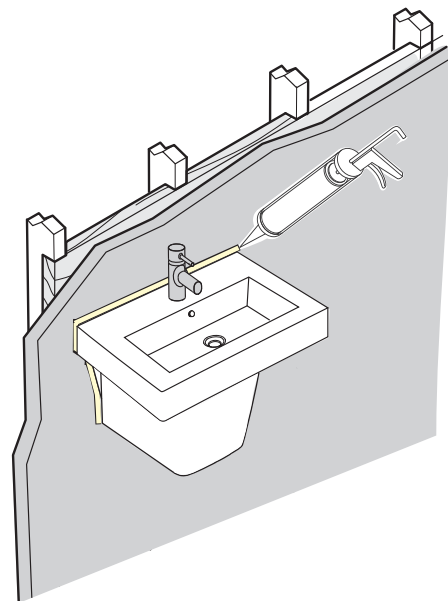

Fig. 1.

* Check shroud is level and secured against basin.

6. All edges **MUST** be sealed with an approved silicone sealant and ensure to wipe away any excess silicone immediately on the wall edges.



Installation complete

CLEANING AND MAINTENANCE INSTRUCTIONS

For cleaning instructions, please refer to the Owner's Information Leaflet.

Basin Cleaning:

- To clean, use non abrasive soap and water. It is recommended that the product surface is wiped dry after each use to prevent the build up of soap and scum.
- Use a soft, dampened sponge or cloth. Never use an abrasive material such as a brush or scouring pad to clean surfaces.
- Be careful not to leave staining materials in contact with the surface for extended periods of time.
- The ideal cleaning technique is to rinse thoroughly and blot dry any water from the surface after each use.

CONTACT AND WARRANTY INFORMATION

NEW ZEALAND

Kohler New Zealand Limited

0800 100 382

info@englefield.co.nz

englefield.co.nz

AUSTRALIA

englefield.com

