

INSTALLATION INSTRUCTIONS



TAPWARE | MASTERFLOW® SHOWER MIXER VALVE 33991A-NP

BEFORE YOU BEGIN:

All information is based on the latest product information at the time of publication. Englefield reserves the right to make changes in product characteristics, packaging, or availability at any time without notice.

Please leave this installation instruction for the consumer as it contains important information.

Notes:

1. Flush the water supply pipes thoroughly to remove debris before installation.
2. An in-line water filter must be used with this product.
3. This mixer valve is intended for both equal and unequal hot & cold water pressures.
4. This mixer valve is not suitable for use in uncontrolled heating systems such as a wet-back or solar heating system unless a proper tempering valve is installed.
5. All connections are G1/2" B.
6. Operating pressure:
 - Equal pressure: Min. 35kPa, Max. 500kPa. If supply exceeds 500kPa a pressure limiting valve must be installed.
 - Unequal pressure: Hot: Min. 35kPa, Max. 120kPa, Cold: Min. 300kPa, Max. 500kPa.
7. Operating temperature:
 - Cold: 5°C to 20°C, Hot: 50°C to 65°C.
8. All connections must be checked for leaks after installation.
9. All installations should comply with the relevant requirements of AS/NZS3500.
10. **DO NOT** hydrostatic test the water supply pipe installation with this shower mixer valve installed. Damage to the ceramic cartridge may occur.
11. Use only water to pressure test this product. Before the test, ensure to flush any air from the mixer valve & pipework thoroughly. Maximum test pressure 800kPa and maximum test duration 30 minutes.

UNEQUAL PRESSURE INSTALLATION

Under unequal pressure conditions, a supplied MASTERFLOW® cartridge jet nozzle shall be fitted & used together with the MASTERFLOW® cartridge to enhance the mixed flow rate and to improve the mixed temperature control.

Use below information to determine the jet nozzle to be used.

<u>Hot inlet pressure</u>	<u>Colour of nozzle</u>
35kPa	White
76kPa	Yellow
120kPa	Red

Note: No MASTERFLOW® cartridge jet nozzle is required under equal pressure conditions.

Remove the plastic sleeve guard. Carefully remove the valve nut & cartridge. Assemble the selected MASTERFLOW® cartridge jet nozzle to the MASTERFLOW® cartridge as shown below.

Carefully re-install the cartridge into the valve body & screw in the valve nut.

Note: Maximum tightening torque for the valve nut is 12Nm.

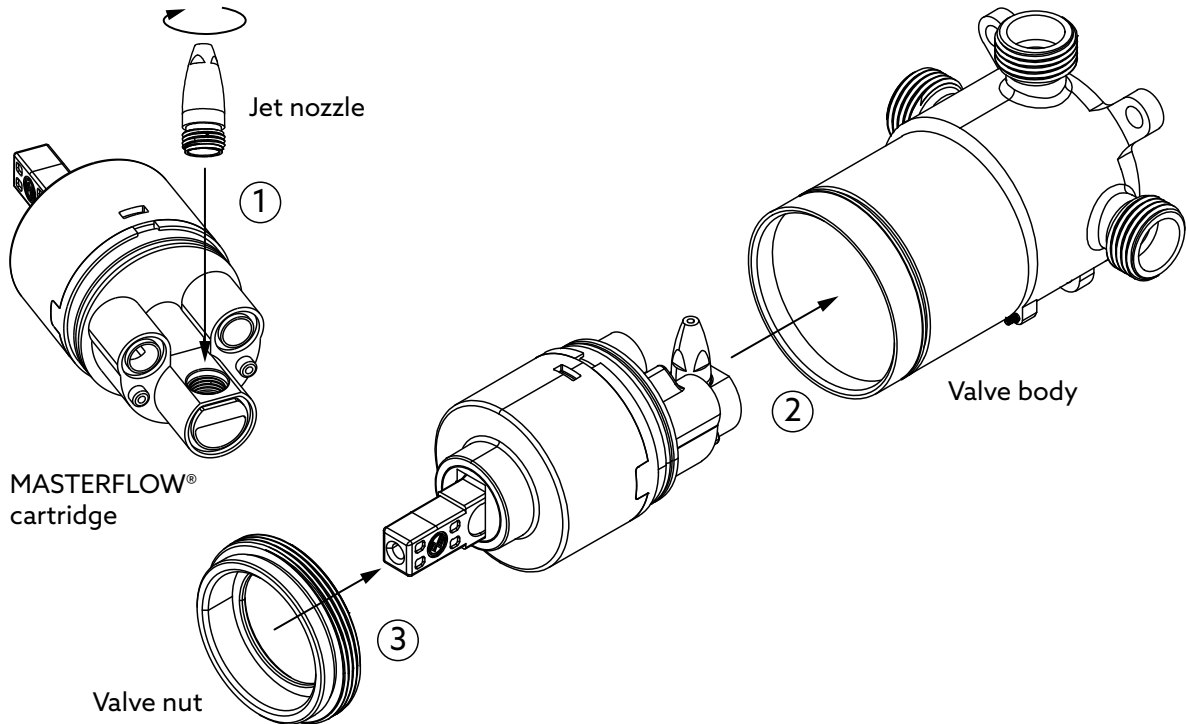

ROUGH-IN:

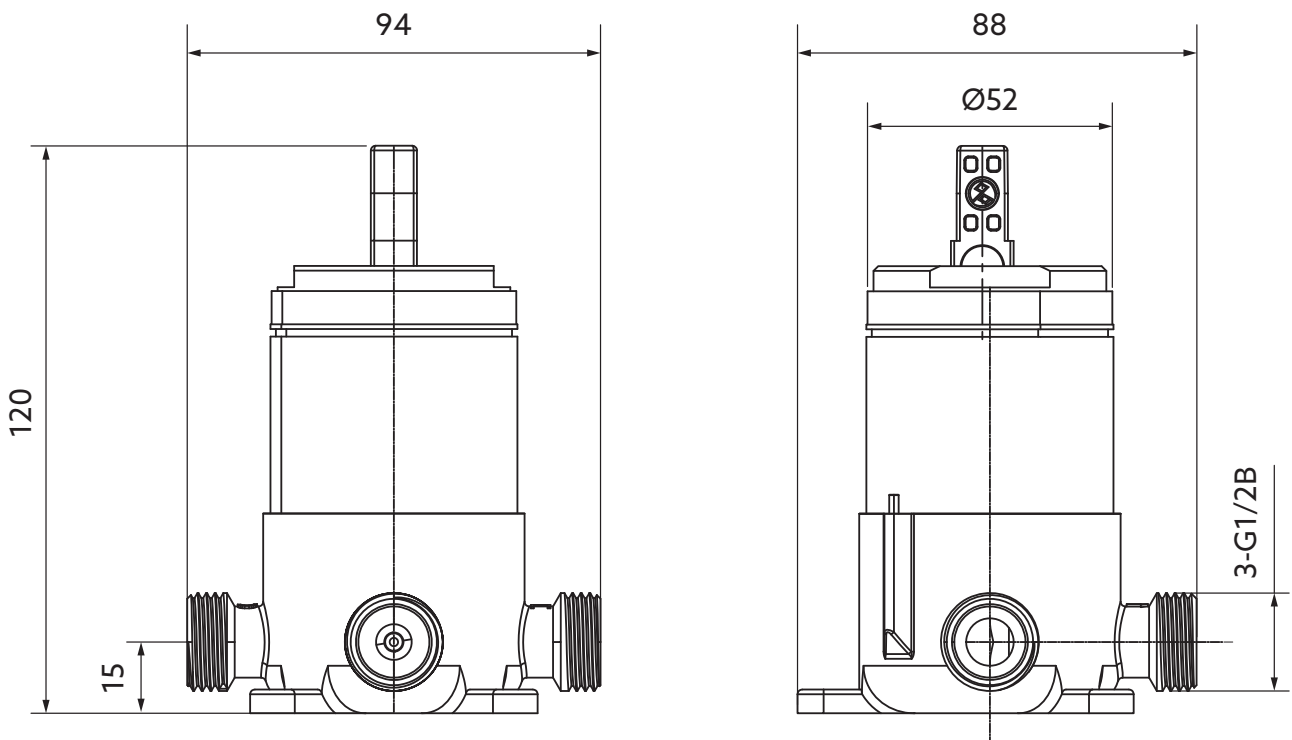

All dimensions in millimetres

INSTALLATION:

1. Determine where the in-wall shower mixer valve will be located in the wall. Construct a suitable nog for mounting it.
2. Ensure the nog is at the correct depth. Distance from mounting surface to the external surface of the finished wall is **between 45mm and 75mm**.

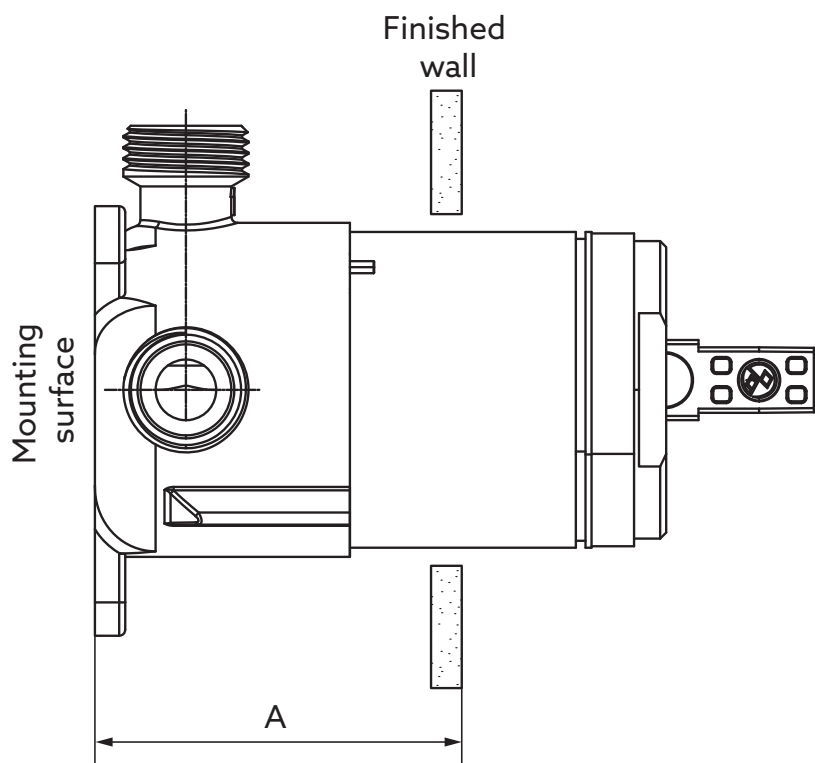

Distance (A) from mounting surface to external surface of the finished wall: **45~75mm**

3. Be sure the arrow marking on the top outlet of the valve body is facing upward, and the hot water connection (H marking) is on the left. Fix the shower mixer valve onto the nog through all three mounting lugs.
4. Connect cold supply, hot supply and outlet pipes to the valve body.
5. Replace the plastic sleeve guard onto the valve body & keep it in place until the shower mixer trim is installed.
Note: Do not seal between the wall lining & shower lining and the valve body until the shower mixer trim is being installed (as there is a further decorative sleeve to be installed).
6. Refer to the Installation Instructions supplied with the selected shower mixer trim to complete the installation.

SPARE PARTS LIST:

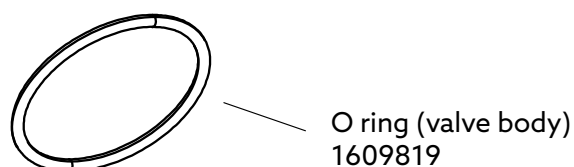
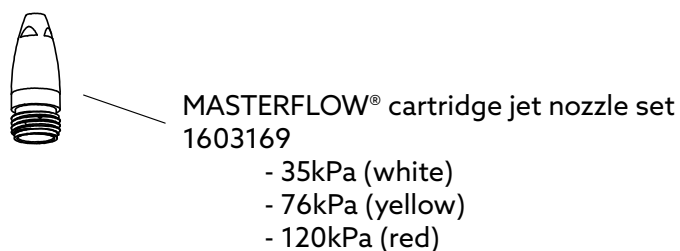
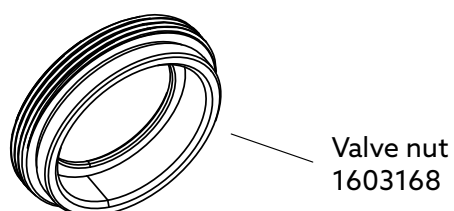
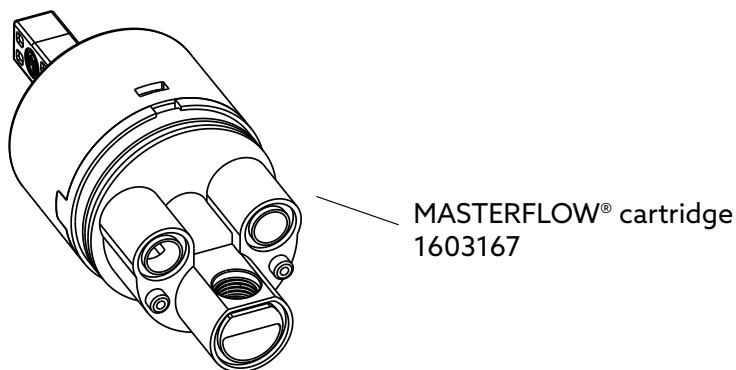

CONTACT AND WARRANTY INFORMATION:

NEW ZEALAND
KOHLER NZ LTD

AUSTRALIA

0800 100 382
info@englefield.co.nz
englefield.co.nz

englefield.com

For warranty information, please visit our website.

