

FURNITURE

VALENCIA® / VALENCIA ELITE® 1200mm Wall Hung Single Bowl/Double Drawers Vanity



With Durastone Vanity Top



With Ceramic Vanity Top



With Stone Vanity Top

Features:

- Wall-hung.
- 3 colour options.
- Single integrated bowl with overflow.
- One pre-drilled tap hole.
- Two spacious soft-close drawers for storage.
- Moisture resistant exterior.
- Fully enclosed rear for easy installation.

Colour/Finish Options:

- Top: White
- Cabinet: White Coastal Oak Urban Oak

Material:

- Top: Hardwearing Durastone®.
- Cabinet: Particle board.
- External surfaces: High gloss polyurethane paint (White) or timber look laminate (Coastal Oak & Urban Oak).

Included Components:

- Vanity cabinet.
- Vanity top.
- Chrome overflow cover.

*Tapwares shown not included.

Technical Details:

Ceramic Tops

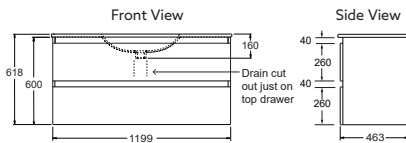
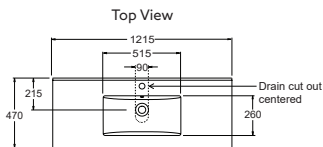

Durastone Tops

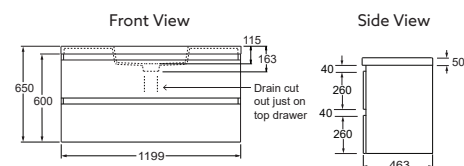
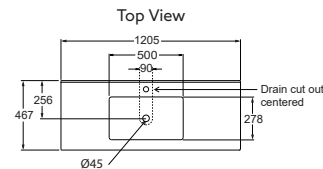

Stone Tops

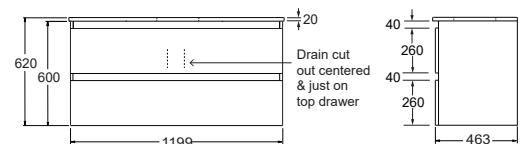
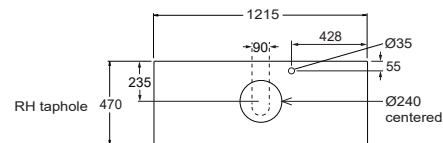
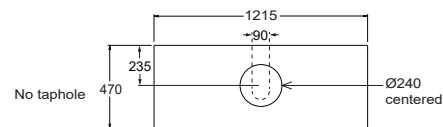

Product Codes:

| No Tapholes | White Stone Top | Grey Stone Top | Black Stone Top |
|----------------|-----------------|----------------|-----------------|
| 1200 mm Vanity | Wall Hung | Wall Hung | Wall Hung |
| White | 99232A-0S01-0 | 99232A-GS01-0 | 99232A-7S01-0 |
| Coastal Oak | 99232A-0S01-LW | 99232A-GS01-LW | 99232A-7S01-LW |
| Urban Oak | 99232A-0S01-DW | 99232A-GS01-DW | 99232A-7S01-DW |

| | Durastone Top | Ceramic Top |
|----------------|---------------|-------------|
| 1200 mm Vanity | Wall Hung | Wall Hung |
| White | 99232A-0 | 30035A-0 |
| Coastal Oak | 99232A-LW | 30035A-LW |
| Urban Oak | 99232A-DW | 30035A-DW |

| Right Tapholes | White Stone Top | Grey Stone Top | Black Stone Top |
|----------------|-----------------|----------------|-----------------|
| 1200 mm Vanity | Wall Hung | Wall Hung | Wall Hung |
| White | 99233A-0S01R-0 | 99233A-GS1R-0 | 99233A-7S01R-0 |
| Coastal Oak | 99233A-0S01R-LW | 99233A-GS1R-LW | 99233A-7S01R-LW |
| Urban Oak | 99233A-0S01R-DW | 99233A-GS1R-DW | 99233A-7S01R-DW |

New Zealand
Kohler New Zealand Limited
 0800 100 382
 info@englefield.co.nz
 englefield.co.nz

Australia
 englefield.com

All measurements shown
 are in millimetres.
 Sizes are approximate.

September 2023
 1564370-A04-B

